

# Isolation Transformer for MagPro System solutions



- For supporting MagPro System solutions with MagPro and other MagVenture devices, an Isolation Transformer is required
- The Isolation Transformer is available in different models for supporting local mains power; 100V~, 120V~ and 230V~
- Outlet for MagPro Stimulator and four 230V auxiliary outlets for other devices such as Treatment Chair, Vacuum Pump Unit and Coil Cooler Unit
- Complies with the leakage current requirements according to IEC 60601-1-1

### Mechanical Properties

Weight of unit	17kg
Height x width x depth	12 x 30 x 23 cm
Cable length primary	3m
Cable length for MagPro	1m
Encapsulation	Overall min 2 mm non-flammable Impact resistant

### Electrical Properties

Mains Voltage Inlet	9016D003-: 120V~, 50/60Hz 9016D004-: 230V~, 50/60Hz 9016D005-: 100V~, 50/60Hz
---------------------	---

Outlet for MagPro	Fixed cable , 230V~, 50/60Hz
Auxiliary outlets	4 pcs. IEC, 230V~, 50/60Hz, Total max 100VA

### Ordering Numbers

9016D003-	(120V~/230V~)
9016D004-	(230V~/230V~)
9016D005-	(100V~/230V~)

### Mains inlet connector

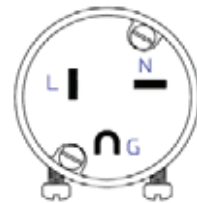

#### 100V and 120V version

Hospital Grade connector  
Rating: 20A/125VAC  
Connector type: NEMA 5-20P

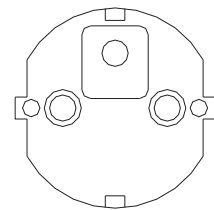

#### 230V version

Shuko connector  
Rating: 10A/250VAC  
Connector type: CEE 7/7

Distributed by:

**ROXON**  
**1-800-361-6991**